

Ward Since 1923
CEDAR LOG HOMES
 Log, Hybrid & Timber Homes
Our past. Your future.

P.O. Box 72
 Houlton, ME 04730
 800-341-1566
 www.wardcedarloghomes.com

ATTIC GARAGE

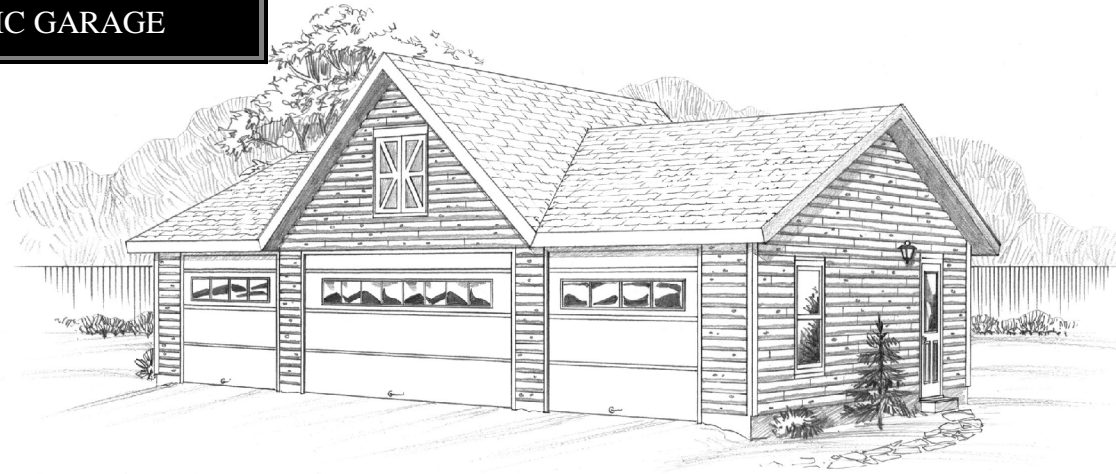

First Floor
 1144 Sq. Ft.

Loft
 208 Sq. Ft.

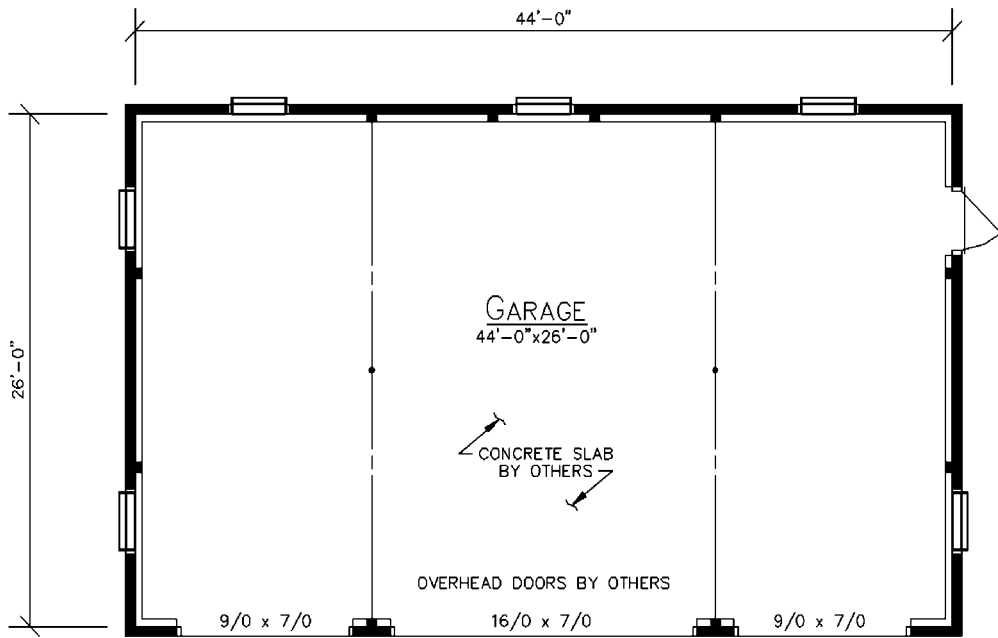

FLOOR PLAN

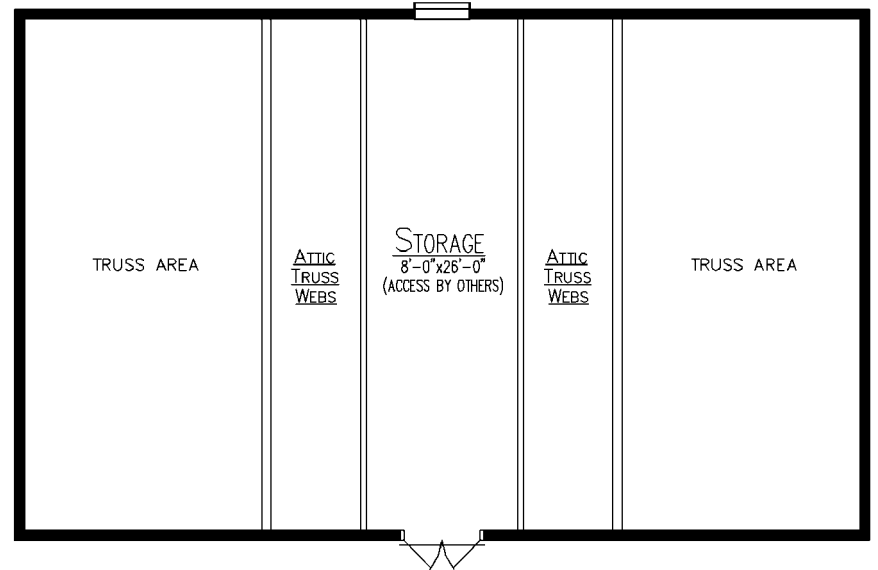

LOFT PLAN