

KINGSWOOD



HOME SPECIFICATIONS

First Floor	1084 Sq. Ft.
Loft	520 Sq. Ft.
Bedrooms	3
Baths	2
Porch	72 Sq. Ft.

- Saltbox Purlin Roof
- Cathedral Ceiling Living Room
- Multi-Use Open Loft
- Twin Angled-Bay Windows
- Open Foyer

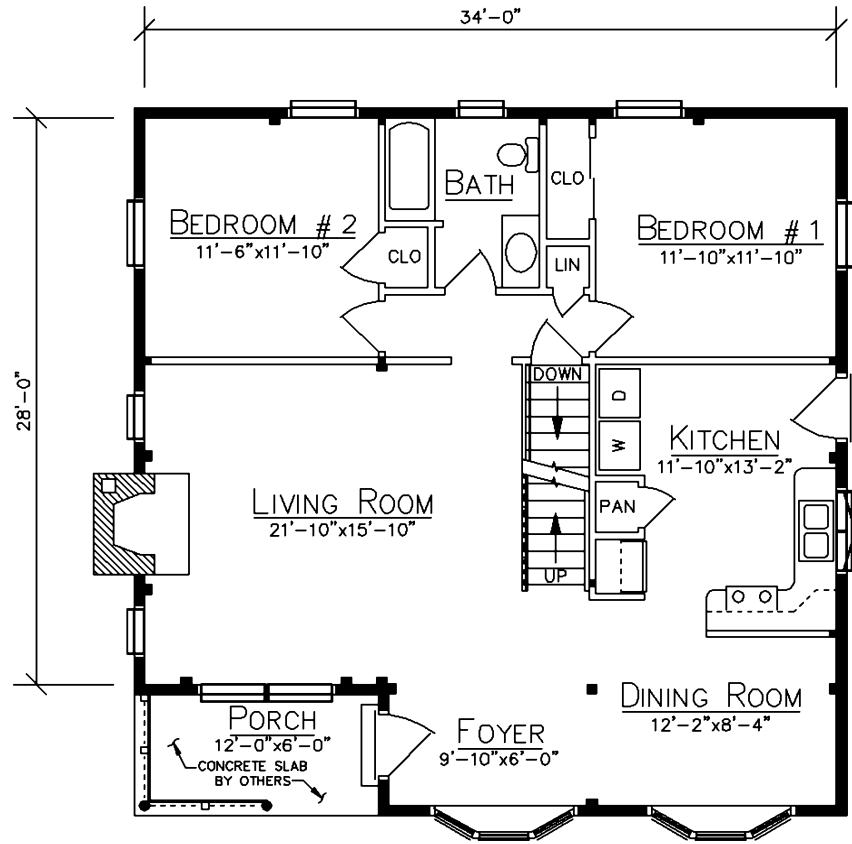

FLOOR PLAN

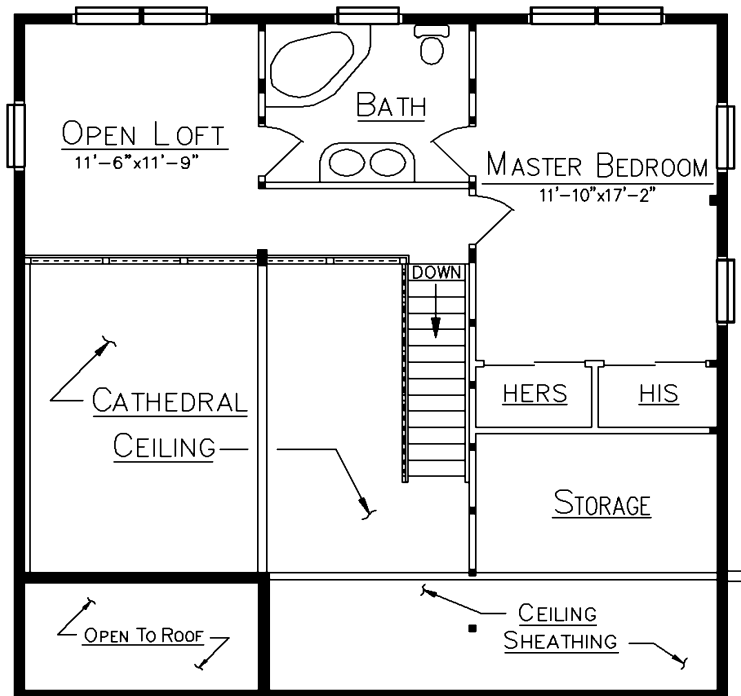

LOFT PLAN

Since 1923
Ward
CEDAR LOG HOMES
Our past. Your future.

Ward Cedar Log Homes

PO Box 72
 Houlton, Maine 04730

1-800-341-1566

info@wardcedarloghomes.com
 www.wardcedarloghomes.com